

NOTES

1. GRC MINIMUM GUIDELINES - IN ACCORDANCE WITH CURRENT
- DEPARTMENT OF TRANSPORT AND MAIN ROADS TRANSLINK DIVISION - PUBLIC TRANSPORT INFRASTRUCTURE MANUAL AND DISABILITY STANDARDS FOR ACCESSIBLE PUBLIC TRANSPORT (DASPT).
  - THE DISABILITY DISCRIMINATION ACT 1992 AND AS/NZS 1428.4.1 - DESIGN FOR ACCESS AND MOBILITY - MEANS TO ASSIST THE ORIENTATION OF PEOPLE WITH VISION IMPAIRMENT - TACTILE GROUND SURFACE INDICATORS (TGSi).

HARDSTAND

2. THE PREFERRED MINIMUM HARD STAND AREA IS 3850MM X 2400MM. A LARGER HARDSTAND AREA IS PREFERRED AND DEPENDENT ON SITE SPECIFIC CONDITIONS.
3. THE MANDATORY (COMPLIANT TO DSAPT) MINIMUM BOARDING POINT HARD STAND AREA IS 1540MM X 2070MM (SHOWN HATCHED) AND SHALL BE CLEAR OF HAZARDS.
4. THE MANDATORY LONGITUDINAL AND CROSS FALL GRADIENT AT THE BOARDING POINT IS A MAXIMUM 1:40 FALL ACROSS THE BOARDING POINT AREA. ALL OTHER HARD STAND AND ADJACENT AREAS TO THE BUS STOP SHALL MEET APPLICABLE STANDARDS IN RELATION TO THE ADJACENT SITE CONDITIONS, AND TO PREFERABLY ACHIEVE A LONGITUDINAL AND CROSS FALL GRADIENT OF MAX. 1:20 FALL.
5. ALL URBAN ROUTE BUS STOPS SHALL BE INSTALLED WITH VERTICAL FACE KERB AND CHANNEL (150mm HIGH) FOR THE FULL LENGTH OF THE DESIGNATED BUS BAY. WHERE EXISTING KERB IS PRESENT TRANSITIONAL KERB SHALL BE INSTALLED AND JOINED NEATLY.

ACCESS

6. WHERE BUS STOPS ARE LOCATED ALONG BICYCLE ROUTES SHARED ACCESS PATHS SHOULD BE APPLIED AS PER LOCAL AUTHORITY REQUIREMENT.
7. CIRCULATION OF WHEELCHAIRS SHOULD BE CONSIDERED AT EACH SITE BASED ON SITE SPECIFIC CONDITIONS AND TO ADDRESS COMPLIANCE WITH DSAPT. MINIMUM WHEELCHAIR CIRCULATION AREA SHALL BE 1540MM x 2070MM TO AS/NZS 1428.4.1 AND MAY OVERLAP THE MINIMUM BOARDING POINT HARD STAND AREA.
8. TACTILE GROUND SURFACE INDICATORS (TGSi'S) SHALL BE INSTALLED AS SHOWN ON THE GLADSTONE REGIONAL COUNCIL DRAWINGS. WHERE THERE IS A PATHWAY ACCESSING A BUS STOP, DIRECTIONAL TGSi'S SHALL BE INSTALLED FOR THE FULL WIDTH OF THE PATH OF TRAVEL OVER A MINIMUM 600MM DEPTH AND PERPENDICULAR TO THE DIRECTION OF TRAVEL WHEN APPROACHING. DIRECTIONAL TGSi'S SHALL BE USED ACROSS THE OPEN SPACE FROM THE ACCESS PATHWAY DIRECTIONAL TGSi'S TO THE BOARDING POINT HAZARD TGSi'S. TGSi'S TO EXTEND TO THE SHORELINE - I.E. BUILDING LINE, WALL, A FENCE, A KERB, OR A GRASS VERGE WHERE APPLICABLE.
9. GLADSTONE REGIONAL COUNCIL'S PREFERRED STANDARD TGSi COLOR IS BLACK FOR LIGHT COLOURED CONCRETE. THE COLOR OF THE TGSi'S SHALL BE SELECTED BASED ON SITE SPECIFIC REQUIREMENTS. INTEGRATED TGSi'S SHALL HAVE A MINIMUM COLOR CONTRAST OF 30% COMPARED TO THE AMOUNT OF LIGHT REFLECTED FROM THE SURFACE OF THE ADJACENT PATH OF TRAVEL. THIS CONTRAST MUST BE MAINTAINED IN BOTH WET AND DRY CONDITIONS.

SHELTER

10. FOR BUS SHELTER DETAILS REFER TO GOSSI PARK DRAWINGS

- CB3924-10101310-01.
- CB3924-10101310-02.
- CB3924-10101310-037.

FURNITURE AND SIGNAGE

11. FOR DETAILS OF BUS STOP SIGNAGE REFER TO GLADSTONE REGIONAL COUNCIL DRAWINGS GRC-B-007 AND 008
12. SEAT TO BE A GOSSI PARK PARKWAY SEAT

- CLEAR ANODISED ALUMINIUM BATTENS
- 2300MM LONG
- 3 ARM RESTS
- BOLTED TO THE SHELTER SLAB
- PRIORITY PLAQUE

13. ALL BIN INFRASTRUCTURE MUST BE DETERMINED BY COUNCIL. BIN SHALL BE

- BIN SHALL BE FROM ALKINA INTERNATIONAL WITH IBIS PROOF LID
- CONVENIENTLY LOCATED (MIN. 1.2m CLEAR OF OTHER BUS STOP SIGN AND/OR BUS STOP INFRASTRUCTURE).
- SHOULD NOT OBSTRUCT PEDESTRAIN PATHWAYS OR MOVEMENTS.
- IF PLACED AT KERB, A MINIMUM CLEARANCE OF 600mm IS REQUIRED FROM FACE OF KERB.
- CONSTRUCTED OF GRAFFITI PROOF MATERIALS

ADDITIONAL REQUIREMENTS

14. ALL BUS STOPS SHALL BE DSAPT COMPLIANT.
15. DIMENSIONS ARE SHOWN IN MILLIMETERS (U.N.O.)
16. WHERE PLANTINGS ARE PROVIDED, USE ONLY GROUND COVER OR LOW SHRUBS (<0.5m HIGH). TREES FOR SHADE SHOULD BE LONG-TRUNKED WITH MINIMUM BRANCH HEIGHT OF 4.5m. PLANTINGS SHOULD NOT OBSTRUCT LINE OF SIGHT BETWEEN APPROACHING BUS AND WAITING PASSENGERS. VEGETATION SHOULD BE CLEAR OF ANY EXISTING SERVICES IN THE AREA.

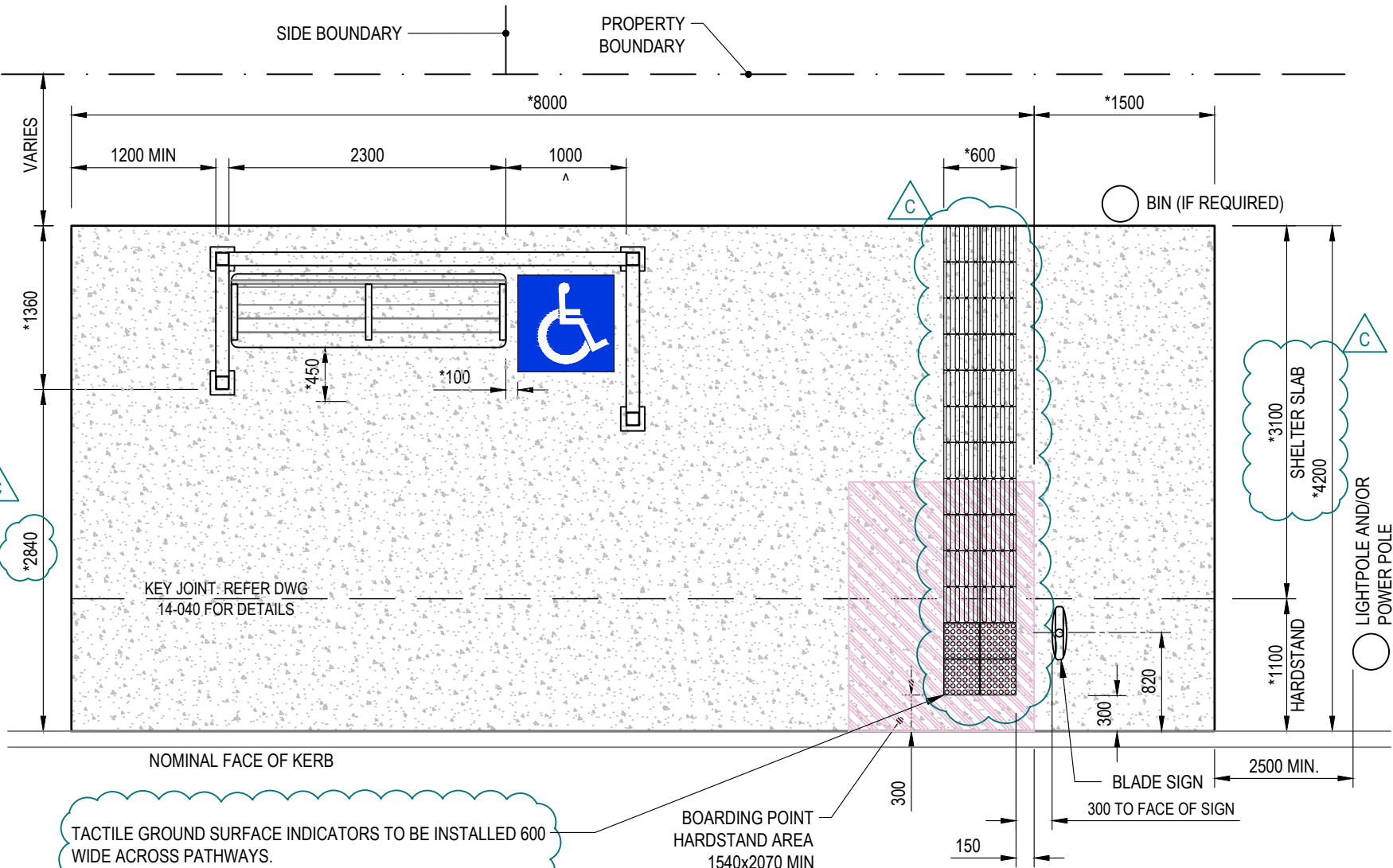

TACTILE GROUND SURFACE INDICATORS TO BE INSTALLED 600 WIDE ACROSS PATHWAYS. INDICATORS TO EXTEND TO EDGE OF PATH/BACK OF SLAB AS PER AS/NZS 1428.4.1.

WARNING TACTILE GROUND SURFACE INDICATORS TO BE:

- TACTILE INDICATOR STUD - DRILL AND LOCK.

DIRECTIONAL TACTILE GROUND SURFACE INDICATORS TO BE:

- DIRECTIONAL BAR - DRILL AND LOCK.

REFER MANUFACTURERS SPECIFICATIONS FOR INSTALLATION.

REFER NOTE 9 FOR COLOUR CONTRAST REQUIREMENTS.

^ EACH DEDICATED SPACE SHALL BE IDENTIFIED BY MEANS OF A WHITE SYMBOL OF ACCESS IN ACCORDANCE WITH AS/NZS 1428.1 BETWEEN 600 MM AND 700 MM HIGH PLACED ON A BLUE RECTANGLE WITH NO SIDE MORE THAN 800 MM, PLACED AS A PAVEMENT PARKING.

\* DENOTES NOMINAL DIMENSION. DIMENSION MAY BE VARIED TO SUIT SITE CONDITIONS WITH COUNCIL APPROVAL. REFER TO LOCALITY AND SET OUT PLAN FOR VARIED DIMENSIONS

PLAN

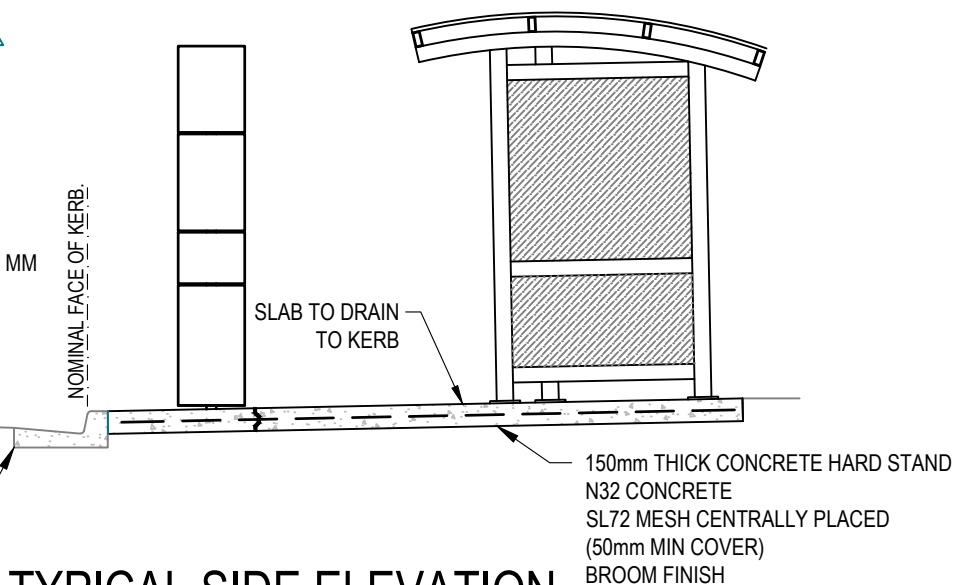

TYPICAL SIDE ELEVATION

SURVEY REF: COORDS: AZIMUTH DATUM: MGA ZONE 56 LEVEL DATUM: AHDD	RL:	AMENDMENTS					SCALES 0 0.5 1.0m (UNO) FULL SIZE A3 SCALE 1:50 AT ORIGINAL SIZE	DESIGNED D.J.CAMPBELL JUN 2014	DRAWN D.J.CAMPBELL JUN 2014	VERIFIED OCT 2014	REPQ No. 04340	RPEQ IAN MUNRO*
		REV	DESCRIPTION	DRAWN	VERIFIED	APPROVED	DATE					
SURVEYED		A	CONSTRUCTION ISSUE	DJC								
		B	TRANSLINK AMENDMENTS	DJC								
		C	AMENDED TO SUIT PTIM 2015	MAB	SGM*	JEK*	02/12/2016					
NOTE * Indicates signatures on original issue of drawing or latest revision of the drawing.												

Gladstone Regional Council		5 Don Cameron Drive, Calliope Qld 4680 P.O. Box 29, Gladstone DC Qld. 4680 Ph. +61 7 49700700 Fax. +61 7 49758500 Email: DesignServices@gladstonerc.qld.gov.au	
GRC		BUS STOP STANDARDS	
BUS STOP - INTERMEDIATE - BLADE SIGN, SHELTER		DETAIL PLAN	

CONSTRUCTION		DRAWING NO.	
GRC-B-004		A3 SHEET	
REVISION		C	