

INDICATIVE CONCRETE PAVEMENT

AADT	# LANES	FLOODWAY WIDTH (m)	CONCRETE DEPTH 'D' (mm) *	SUBBASE COURSE (mm)	MPa	JOINTING	REINFORCEMENT
≤ 50	1	4.2	160	125	32	Transverse joints at 4.2m -5.2m spacing	SL92 mesh 50mm top cover, 28mm dowels
50 to 150	2	6.5	175	125	32	Longitudinal joint at road centerline Transverse joints at 3.5m to 4.25m spacing	
150 to 300	2	8	175	125	32	Longitudinal joint at road centerline Transverse joints at 4m to 5.2m spacing	
300 to 1500	2	8	190	150mm lean mix 5MPa	40	Longitudinal joint at road centerline Transverse joints at 4m to 5.2m spacing	
1500 ≥				Project Specific			

*** Design Parameters**

- 30 year design life
- CBR 3% min
- Max 1500 AADT with 15% HV
- 2% growth
- 2.8 H_{HVAG}
- 1.1 L_{sf}

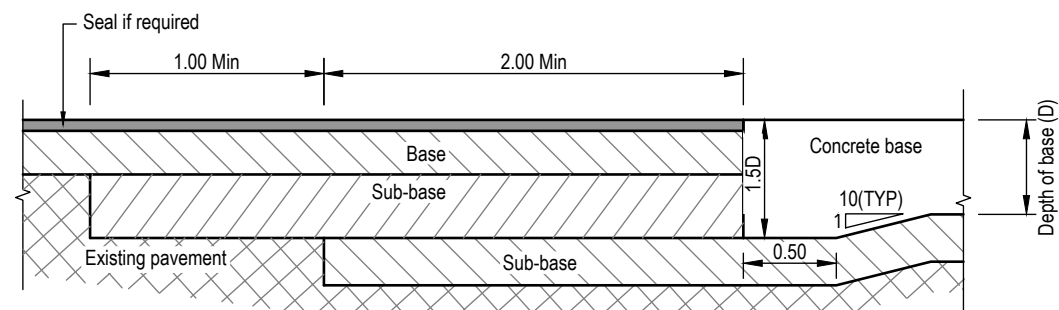

CONCRETE TO FLEXIBLE PAVEMENT TRANSITION DETAIL

N.T.S

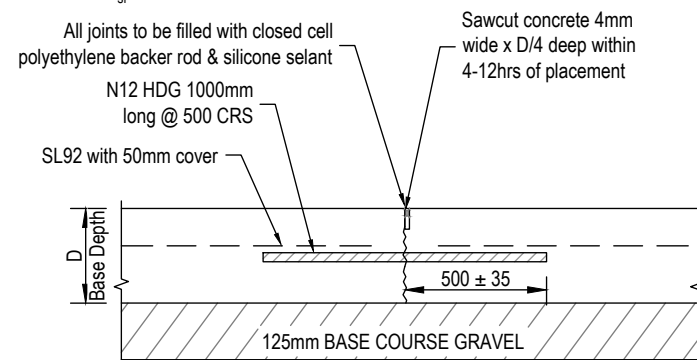

**JOINT TYPE
LONGITUDINAL: TIED AND SAWN**
N.T.S

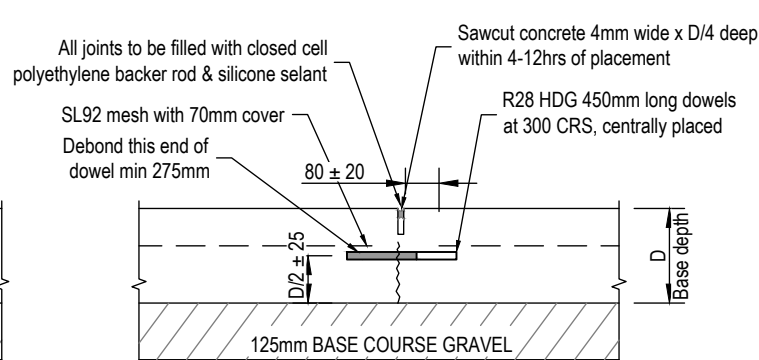

**JOINT TYPE
TRANSVERSE CONTRACTION:
SAWN AND DOWELLED**
N.T.S

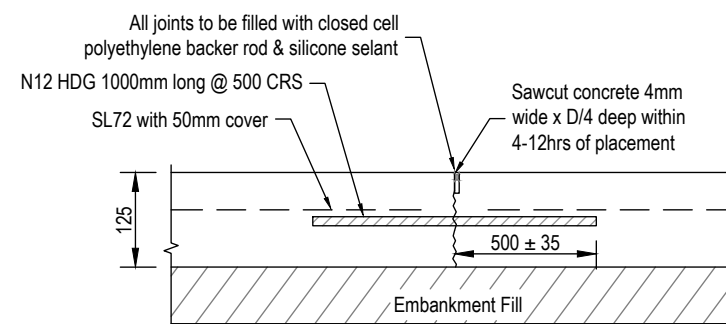

**BATTER JOINT DETAIL
LONGITUDINAL: TIED AND SAWN**
N.T.S

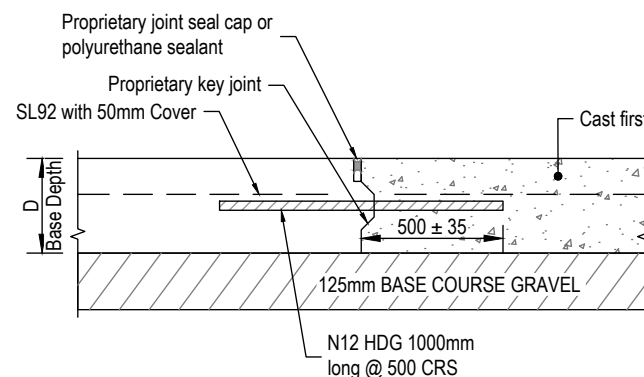

**JOINT TYPE
LONGITUDINAL: TIED AND FORMED**
N.T.S

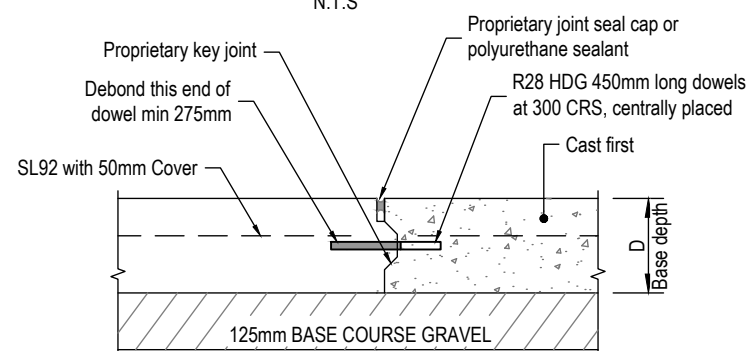

**JOINT TYPE
TRANSVERSE CONTRACTION:
FORMED AND DOWELLED**
N.T.S

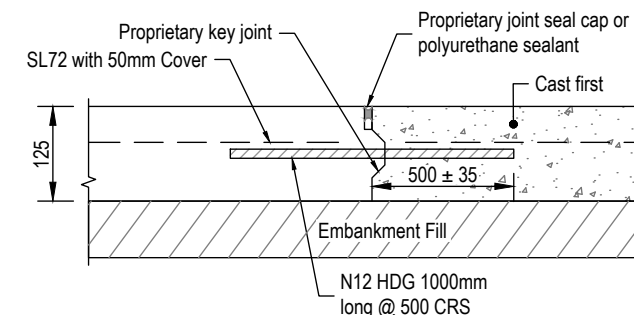

**BATTER JOINT DETAIL
LONGITUDINAL: TIED AND FORMED**
N.T.S

NOTES:

1. Reinforced concrete to be as per AS 3600
2. Batter protection joints to align with pavement joints
3. To be used in conjunction with CMDG-R-094, CMDG-R-095 & CMDG-R-096

DRAWING APPLICABILITY TABLE							
Council	BSC	CHRC	GRC	IRC	LSC	MRC	RRC
Applicable	Yes	Yes	Yes	Yes	Yes	Yes	Yes
Alternative DWG	CMDG-R-094A						

REVISIONS	DATE
A	12/2025

DISCLAIMER.
The authors and sponsoring organisations shall have no liability or responsibility to the user or any other person or entity with respect to any liability, loss or damage caused or alleged to be caused, directly or indirectly, by the adoption and use of these Standard Drawings including, but not limited to, any interruption of service, loss of business or anticipatory profits, of consequential damages resulting from the use of these Standard Drawings. Persons must not rely on these Standard Drawings as the equivalent of, or a substitute for, project-specific design and assessment by an appropriately qualified professional.

Capricorn Municipal Development Guidelines
Incorporating:
Banana Shire Council (BSC) Maranoa Regional Council (MRC)
Central Highlands Regional Council (CHRC) Rockhampton Regional Council (RRC)
Gladstone Regional Council (GRC) Isaac Regional Council (IRC)
Livingstone Shire Council (LSC)

**FLOODWAY
SECTIONS AND DETAILS**

ROADS	
STANDARD DRAWING	A3
CMDG-R-097	
REV.	A